

Massivholzplatten quadratisch - Plattenstärke 30 mm mit Randaufdoppelung auf 60 mm

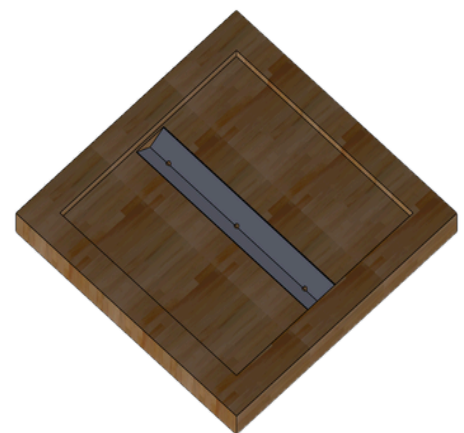

Massivholzplatten rechteckig - Plattenstärke 30 mm mit Randaufdoppelung auf 60 mm

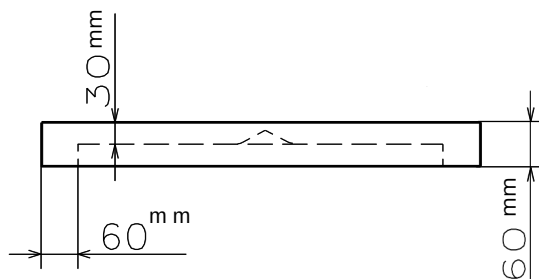
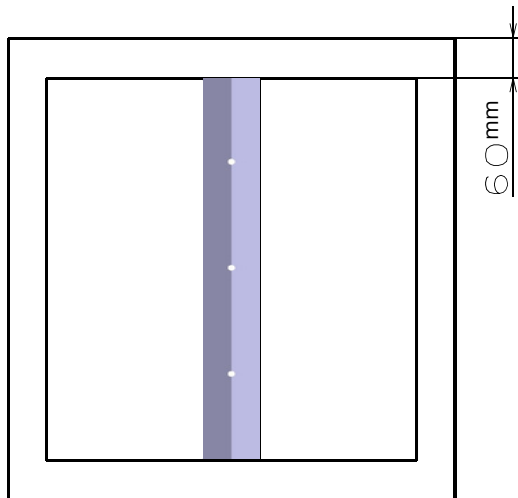
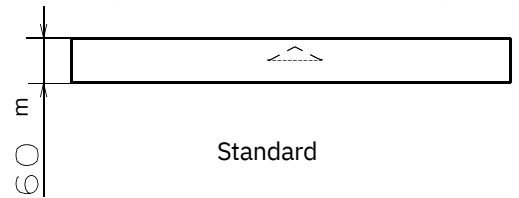
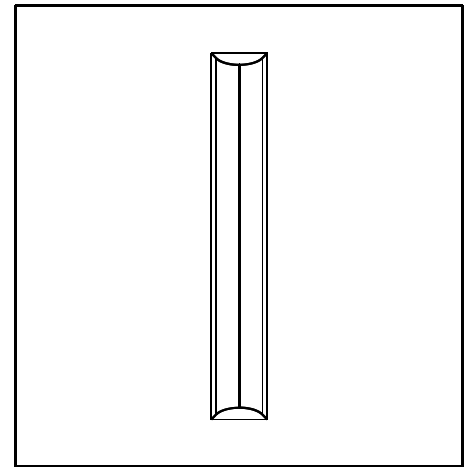
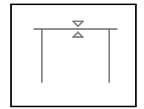
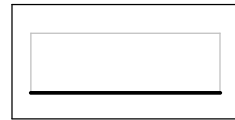
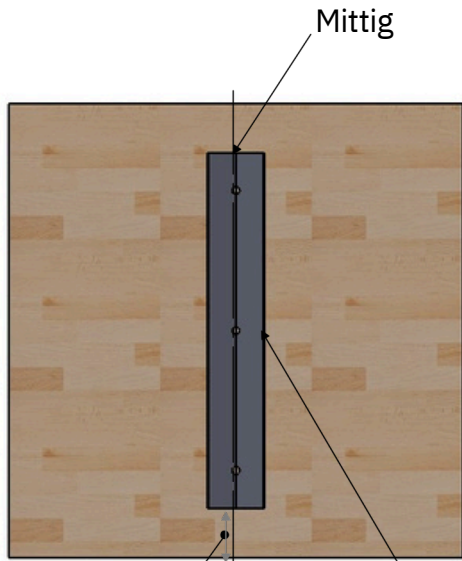
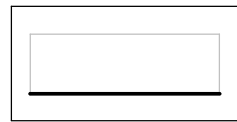

100 bis
170 cm



40 bis
100 cm

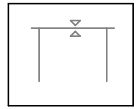

30 mm
60 mm

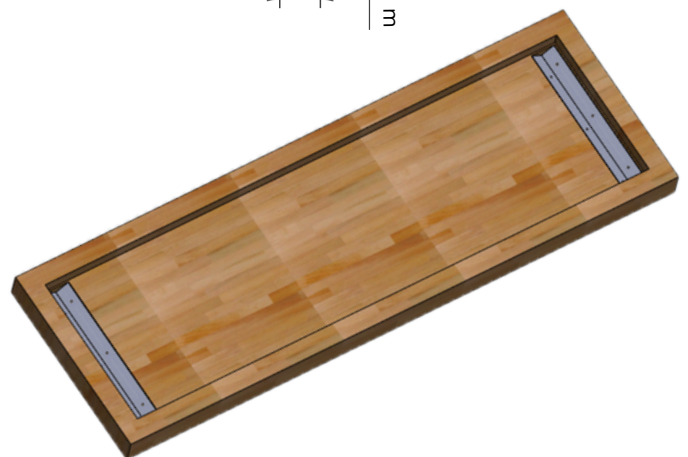
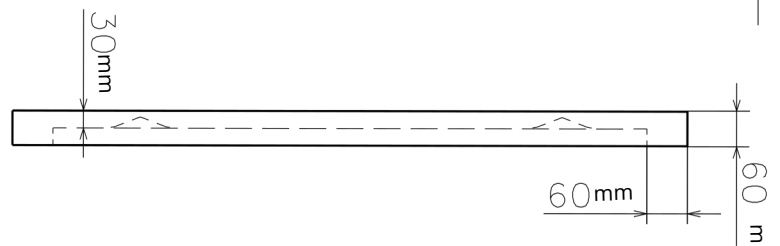
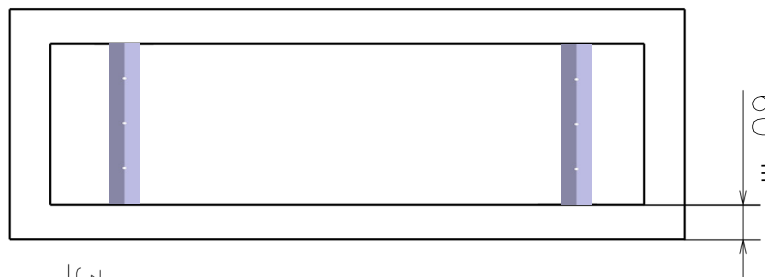
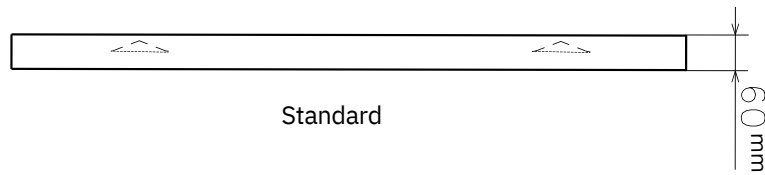
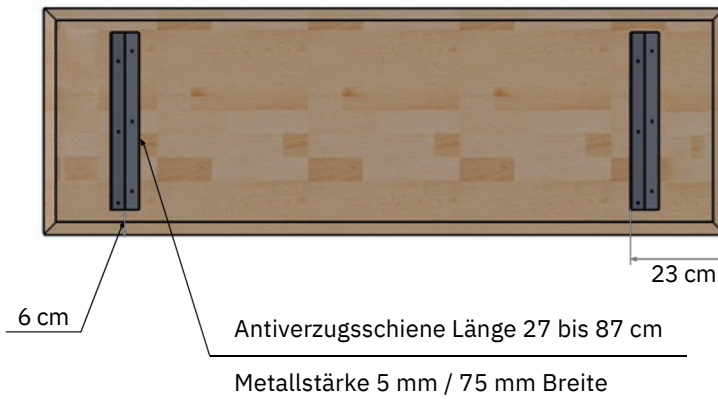

Massivholzplatten rechteckig - Plattenstärke 30 mm mit Randaufdoppelung auf 60 mm

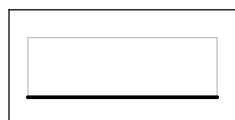

180 bis
230 cm



40 bis
100 cm

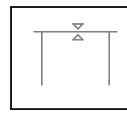

30 mm
60 mm

